

# Orange County Public Schools



Phillis Wheatley Elementary School  
Community Meeting

**SCHENKELSHULTZ**  
ARCHITECTURE

## Phillis Wheatley Elementary School Meeting Agenda

September 23, 2013 Apopka 9th Grade Center, 6:00 PM

- Introductions – Principal: Sean Brown
- Welcome – School Board Member: Christine Moore
- Project Update – Facilities Meeting Organizer  
Architect: **SCHENKEL**SHULTZ  
□□□ ARCHITECTURE □□□  
General Contractor: Gilbane
- Technology Update
- Questions and Answers

# Orange County Public Schools





# Orange County Public Schools

## Data

500 student stations

59,743 new square feet

1,788 gym addition square feet

12,986 existing gym square feet

74,517 total square feet

84 parking spaces

42 single lane car stacking

2 buses

16 security cameras

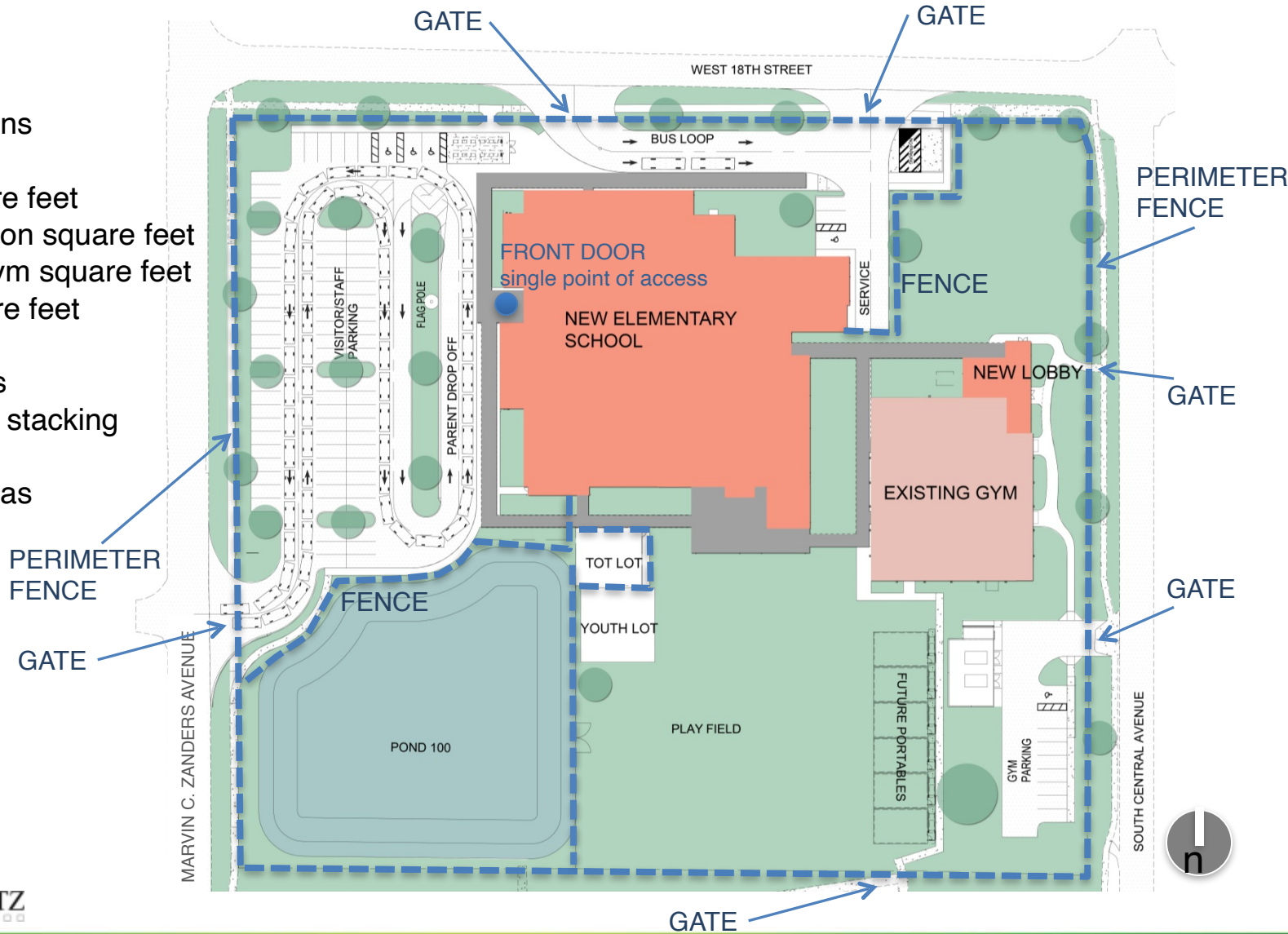



# Orange County Public Schools



ADMIN



**SCHENKELSHULTZ**  
ARCHITECTURE



CLASSROOM



# Orange County Public Schools



ART



MUSIC



MEDIA



CAFETERIA

# Orange County Public Schools





# Orange County Public Schools

## Phillis Wheatley

Born in Senegal about 1753, Phillis Wheatley was brought to Boston, Massachusetts, on a slave ship in 1761, and was purchased by John Wheatley as a personal servant to his wife. The Wheatleys educated Phillis, and she soon mastered Latin and Greek, and began writing poetry.

She published her first poem at age 12, and her first volume of poetry, *Poems on Various Subjects, Religious and Moral*, in 1773. She died in Boston in 1784.

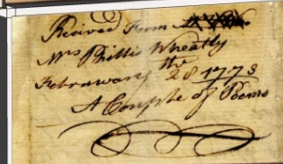
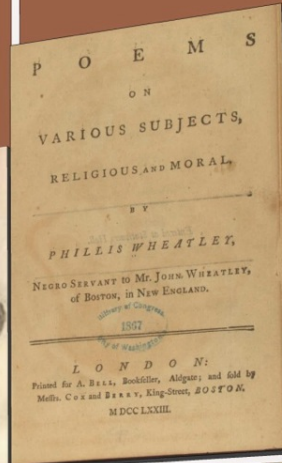

# Orange County Public Schools



# Orange County Public Schools





# Orange County Public Schools



**SCHENKELSHULTZ**  
○○○ ARCHITECTURE ○○○

Exterior view from Marvin C. Zanders Avenue



# Orange County Public Schools



**SCHENKELSHULTZ**  
○○○ ARCHITECTURE ○○○

Exterior view of entry



# Orange County Public Schools



**SCHENKELSHULTZ**  
○○○ ARCHITECTURE ○○○

Exterior view from southwest



# Orange County Public Schools



**SCHENKELSHULTZ**  
○○○ ARCHITECTURE ○○○

Gym view from South Central

## Schedule

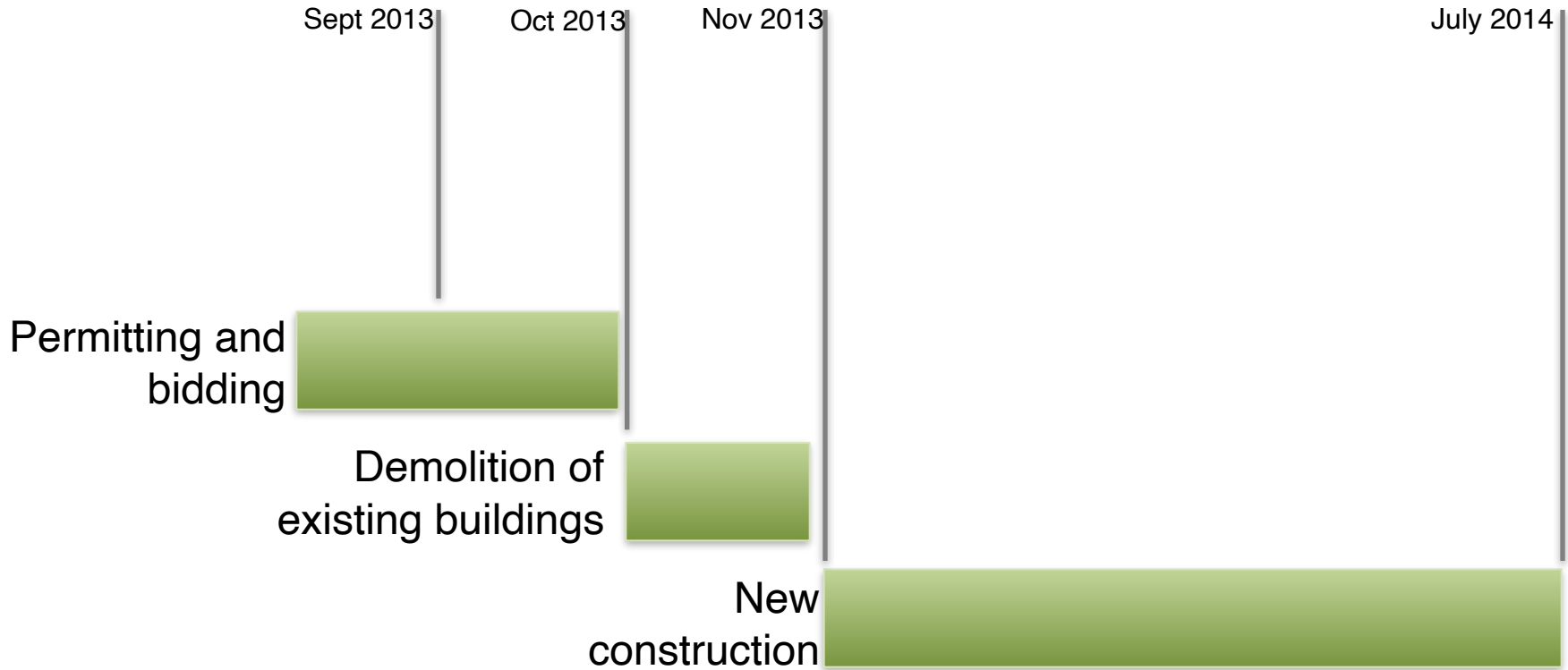

# Technology Update



## 2015 Digital Curriculum Goals

### Campus technology

- Computers in classrooms
  - Wireless access
- Digital projectors
- Interactive instructional surface that allows integration of digital content into teaching/learning
- Audio enhancement allowing teacher to be heard regardless of location in classroom

## 2015 Digital Curriculum Goals Cont.

Increased technology requires improved infrastructure

- Upgrade to the fiber optic backbone
- Adequate electrical outlets and power supply
- Audio enhancement, projectors and wireless equipment

# Questions and Answers